

Float Valve

Fig. A100

Function

The float valve is a type of on/off valve, which can accurately control the liquid level of the pool and tank. The valve is designed to open wide when the liquid level reaches a preset low and close without drip when the liquid level reaches a preset high.

Schema

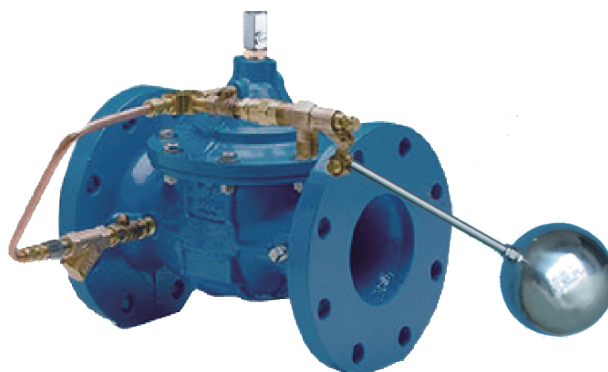

Materials

Parts	Name	Material	Standard
1	Main valve	Cast Iron Ductile Iron	EN-GJL-200 EN-JS 1050
2	Ball valve	Brass	EN 12165 W603N
3	Filter	Brass	EN 12165 W603N
4	Throttle plates	Brass	EN 12165 W603N
5	Ball valve	Brass	EN 12165 W603N
6	Throttle	Brass	EN 12165 W603N
7	Float pilot	Brass	EN 12165 W603N
8	Ball valve	Brass	EN 12165 W603N
Vertical mounting option	Spring assembly	SS	BS970 304 S15

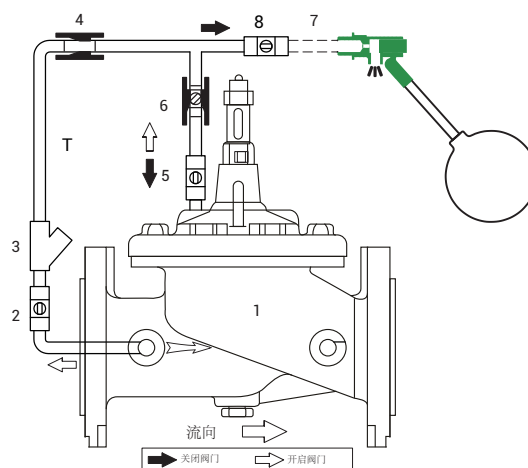

Working Principle

The main valve is open

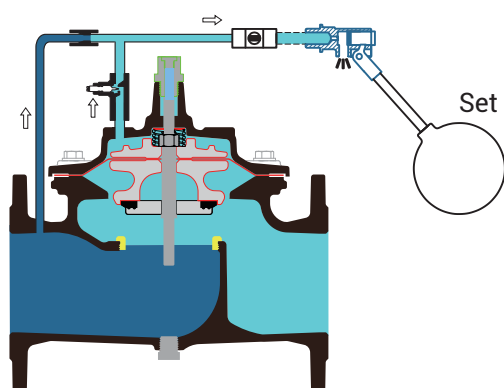

Water low → pilot valve opens → main valve drains → main valve opens.

The main valve is closed

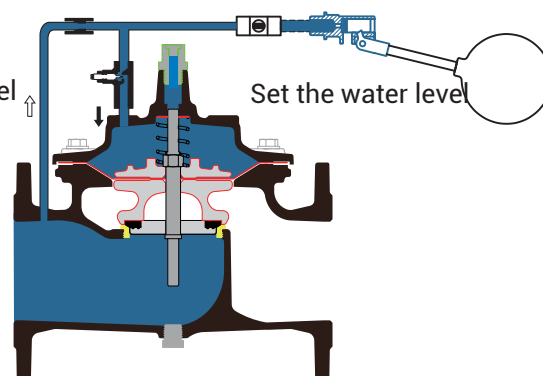

Water reaches pilot valve level → valve closes → water fills bonnet chamber → main valve closes.

Installation Points

- 1、Filter protects main valve.
- 2、Shut-off valve eases maintenance.
- 3、Anti-wave device protects float.
- 4、Max 45° tilt for horizontal install.
- 5、Vertical install needs spring (optional).

Value-added features

1. Float valve with check function
2. Float valve with solenoid valve function (A161)

Typical Applications

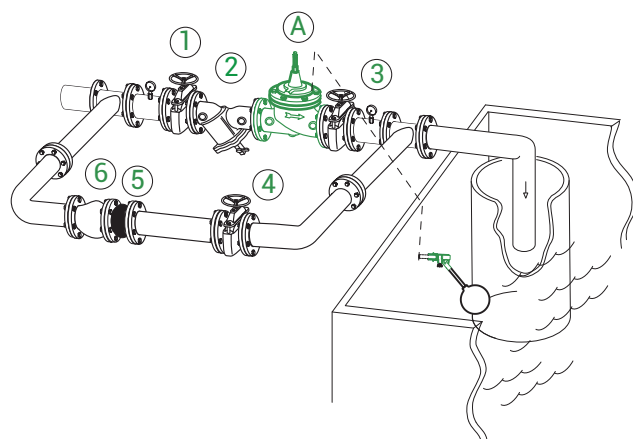

Highly recommended
Anti-wave device

Float valves are often installed above the high water level in the pool, and if there is turbulence and ripples on the surface of the liquid, it must be installed at the inlet to prevent waves.

1、3、4: Shut-off valve 2: Filter 5: Soft joints 6: Check valves A: Float pilot valve