

# Globe Valve Threaded

Fig. 8940

## Standard

Connection meet: ISO228/1

Size range: 20mm(3/4")~25mm(1")

Testing Standard: EN12266-1

## Technical data

Nominal pressure: 25 bar。

Size: DN20~DN25

Testing pressure: Shell: 37.5bar

Seal: 27.5bar

Working ΔP: 1.8 bar

Temperature range: 5°C ~ 100°C

Media: Water, Glycol

Actuators: EST/ESMSeries

## Specification

Part	Material	Material
Body	Brass	CW617N
Bonnet	Brass	CW617N
Gland	Brass	CW617N
Shaft	Brass	CW617N
O-ring	EPDM	
Stop collar	Stainless Steel	SS304
Spring	Stainless Steel	SS304

## Dimensions

DN	mm	20	25
	inch	3/4	1
H		45.2	46.7
L		65	80
H1		14.7	14.7
A		M30X1.5	M30X1.5
Connection		G 3/4"	G 1"
Kvs		3.5	4.6

## Schema

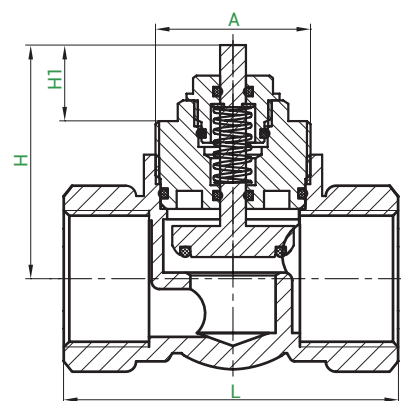

## Notice

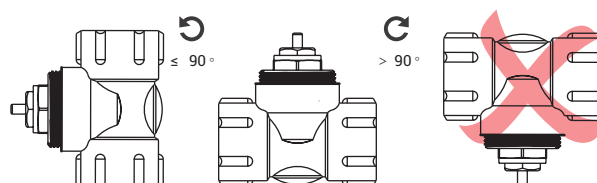

1. Actuator must be horizontal;
2. Do not use force on the drive during installation;
3. The thread connected with the valve must be standard thread
4. The valve and pipeline should be kept clean before installation;
5. The valve and pipe recommended horizontal installation, can be installed vertically, but not inverted;
6. Ensure that the pipes and valves are insulated and do not wrap the Actuator in the thermal insulation layer.

Note: If the product is damaged due to improper installation or