

2-Way Thermal Globe Valve-On-off-Threaded

Fig. 8940+EST31

Standard

Connection meet: ISO228/1

Size range: 20mm(3/4")~25mm(1")

Testing Standard: EN12266-1

Technical data

Supply Voltage: AC220V±10%, 50/60HZ

Power consumption: 3VA (Only in action)

Type: Thermal

Stroke: 4 mm

Operation time: 4.5min

Torque: 90 ~ 125N

Wire length: 750mm

Enclosure protection: IP54

Nominal pressure: 25 bar。

Size: DN20~DN25

Testing pressure: Shell: 37.5bar / Seal: 27.5bar

Working ΔP: 1.8 bar

Temperature range: 5°C ~ 100°C

Media: Water, Glycol

Specification

Part	Material	Standard
Body	Forged Brass	BS EN12165 CW617N
Trim	Brass	BS EN12165 CW617N
Seal	PTFE	-
Thermal Actuator	Plastic	Component

Dimensions

DN	mm	20	25
	inch	3/4	1
H		92	96
L		65	80
H1		64	64
A		Φ45.6	Φ45.6
Connection		Rp 3/4"	Rp 1"
Kvs		3.5	4.6

Schema

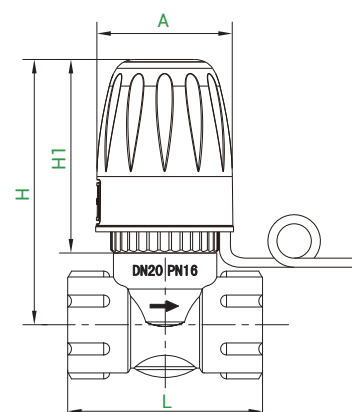

Wiring

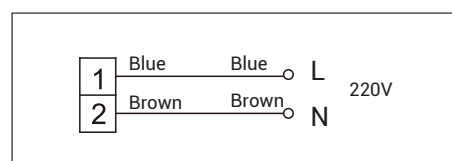

Notice

1. Actuator must be horizontal;
2. Do not use force on the drive during installation;
3. The thread connected with the valve must be standard thread
4. The valve and pipeline should be kept clean before installation;
5. The valve and pipe recommended horizontal installation, can be installed vertically, but not inverted;
6. Ensure that the pipes and valves are insulated and do not wrap the Actuator in the thermal insulation layer.

Note: If the product is damaged due to improper installation or

WA reserves the right to change dimensions without notice.